

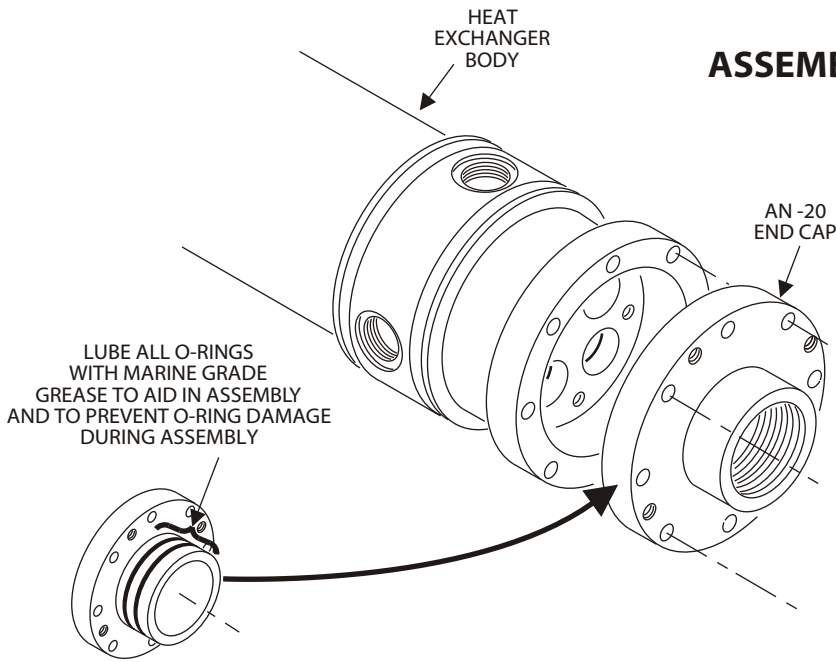

# ASSEMBLY



## STEP 1

USING FOUR **10-24 x 1 3/4"** ALLEN SCREWS, CAREFULLY TIGHTEN IN A CLOCKWISE ROTATION. DRAW THE END CAP INTO THE HEAT EXCHANGER BODY. TIGHTEN THE SCREWS ONLY UNTIL THEY GENTLY BOTTOM OUT, THEN REMOVE THE SCREWS.

ROTATED 108°

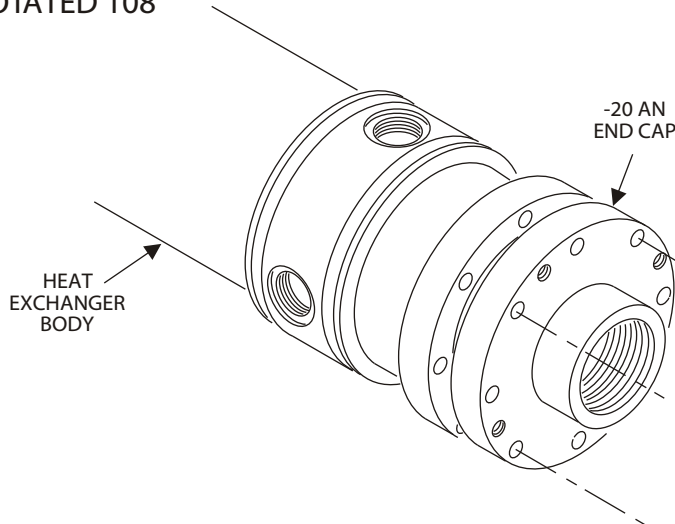

## STEP 2

USING FOUR **10-24 x 1 1/4"** ALLEN SCREWS, CAREFULLY TIGHTEN IN A CLOCKWISE ROTATION TO CONTINUE TO DRAW THE END CAP INTO THE HEAT EXCHANGER BODY. TIGHTEN THE SCREWS ONLY UNTIL THEY GENTLY BOTTOM OUT, THEN REMOVE THE SCREWS.

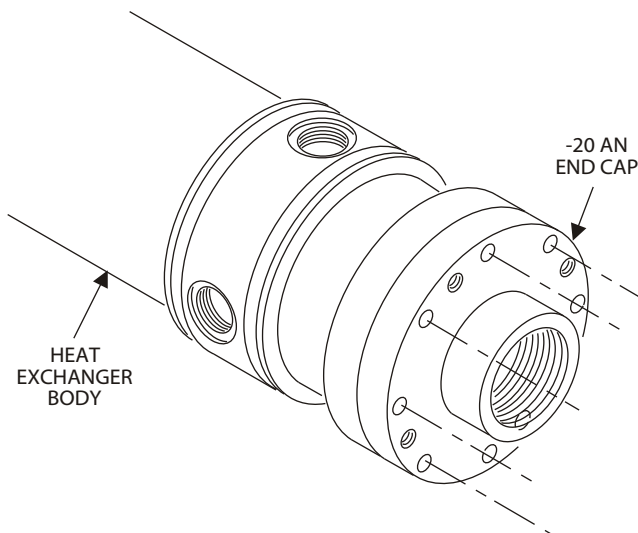

## STEP 3

USING EIGHT **10-24 x 3/4"** ZINC ALLEN SCREWS, FINALLY, SECURE THE END CAP TO THE HEAT EXCHANGER BODY. CAREFULLY TIGHTEN IN A CLOCKWISE ROTATION TO CONTINUE TO DRAW END CAP INTO THE HEAT EXCHANGER BODY. TIGHTEN THE SCREWS.