

# ROCK RACER Full Hydraulic System W/ RELIEF VALVE

## Hose installation diagram

POWER STEERING FLUID: Howe Power Steering Fluid PN 1105  
(GM AC Delco PN:19329448 may be substituted if needed)

**CAUTION:**  
**DO NOT USE ATF (AUTOMATIC TRANSMISSION FLUID)**

NOTE: Hose lengths will vary with each installation, custom hoses must be fabricated.

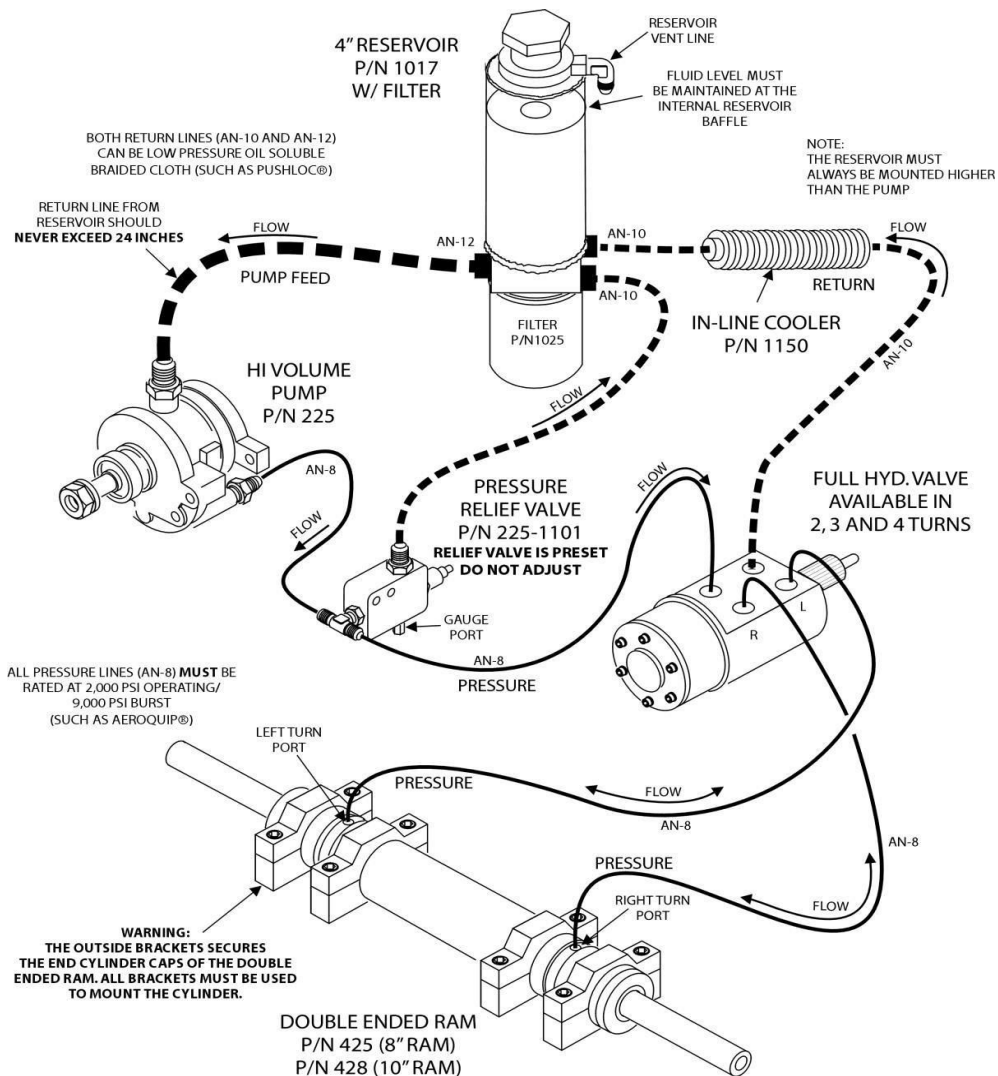

IF YOU HAVE ANY QUESTIONS ABOUT THE INSTALL CALL HOWE PERFORMANCE (619) 561-7764  
HOSE SPECIFICATIONS

**-10 Low Pressure Hose Specs:** Hose I.D. .63", Hose O.D. .91", 250 PSI, 300 degrees Fahrenheit

**-12 Low Pressure Hose Specs:** Hose I.D. .75", Hose O.D. 1.03", 250 PSI, 300 degrees Fahrenheit

**-8 High Pressure Hose Specs:** Hose I.D. 13/32", Hose O.D. 49/64", 2,000 Working PSI, 8,000 Burst PSI, 302 degrees