

# TOYOTA POWER STEERING & RAM

**POWER STEERING FLUID:** Howe Power Steering Fluid PN 1105 (GM AC Delco PN:19329448 may be substituted if needed)

**CAUTION:** DO NOT USE ATF (AUTOMATIC TRANSMISSION FLUID)

**NOTE:** Hose lengths will vary with each installation, custom hoses must be fabricated. Hoses and fittings are available separately.

## HOSE SPECIFICATIONS

-8 Low Pressure Hose Specs: Hose I.D. .50", Hose O.D. .75", 250 PSI, 300° F

-10 Low Pressure Hose Specs: Hose I.D. .63", Hose O.D. .91", 250 PSI, 300° F

-6 High Pressure Hose Specs: Hose I.D. 5/16", Hose O.D. 43/64", 2,250 working PSI, 9,000 Burst PSI, 302° F

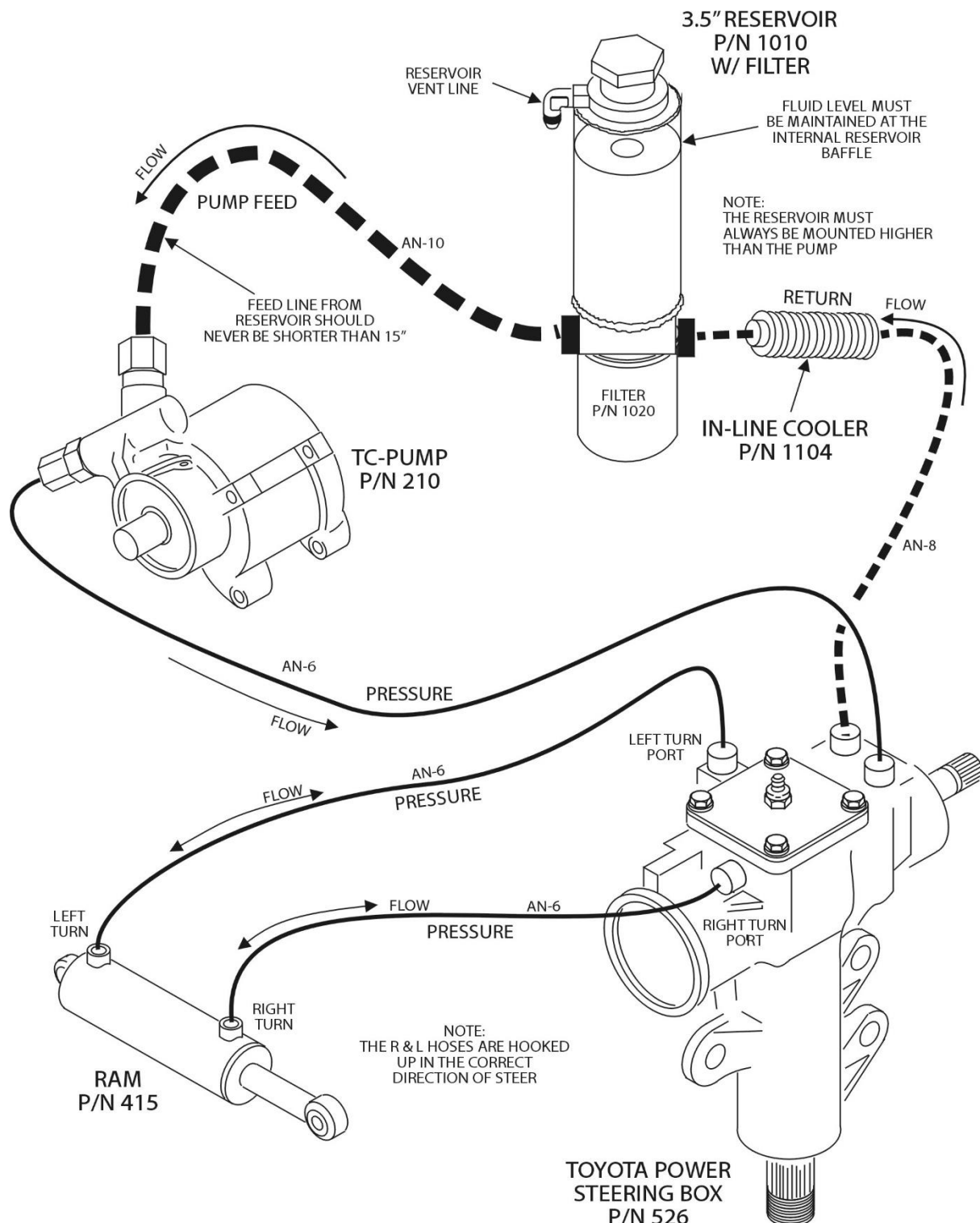

IF YOU HAVE ANY QUESTIONS ABOUT THE INSTALL CALL HOWE PERFORMANCE (619) 561-7764