

DIABLO SYSTEM 2.0

Hose installation diagram

POWER STEERING FLUID: Howe Power Steering Fluid PN 1105
(GM AC Delco PN: 19329448 may be substituted if needed)

CAUTION:

DO NOT USE ATF (AUTOMATIC TRANSMISSION FLUID)

Use only Sta-Lube Marine grease p/n SI3120 (tube), SI3121 (tub)

NOTE: Hose lengths will vary with each installation, custom hoses must be fabricated.

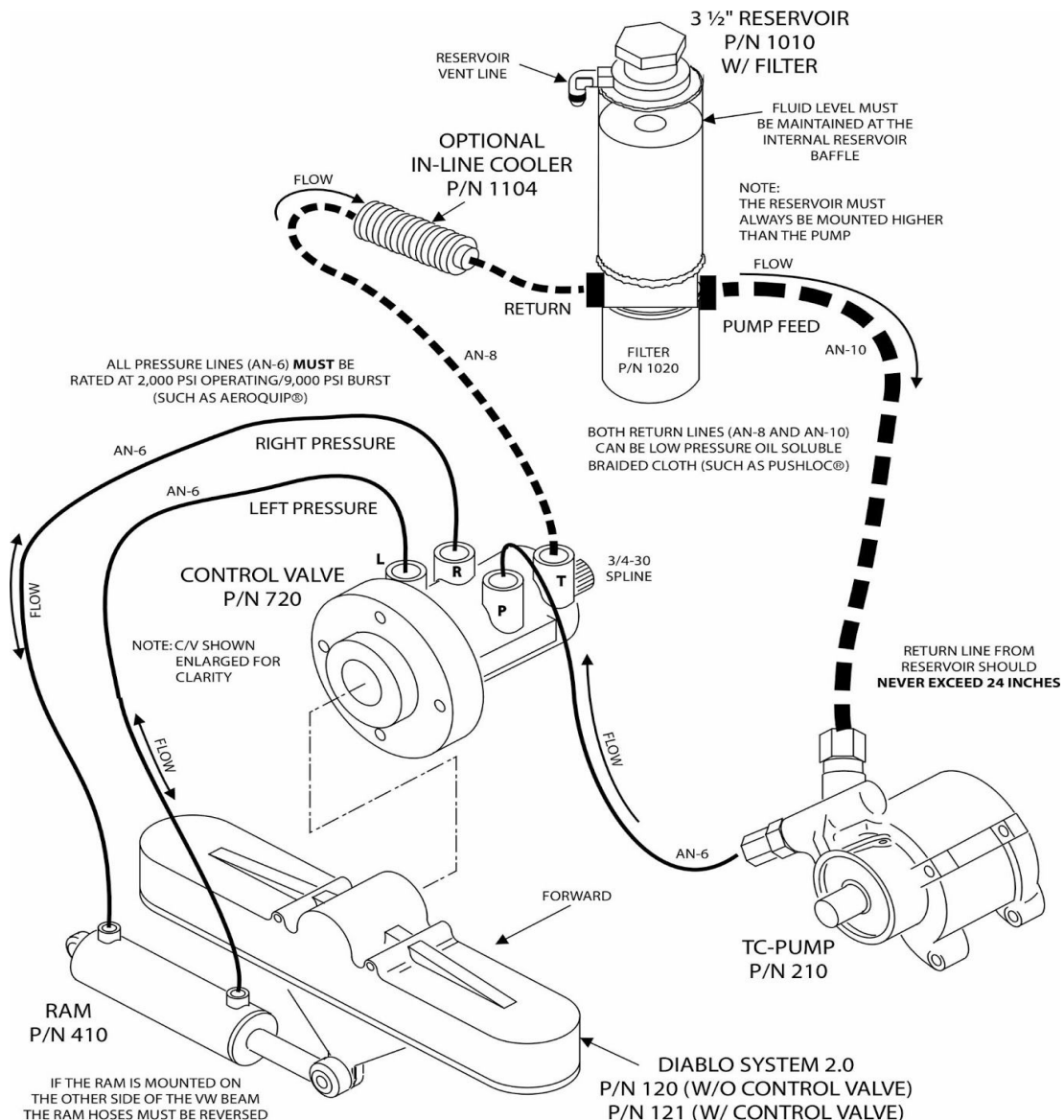

IF YOU HAVE ANY QUESTIONS ABOUT THE INSTALL CALL HOWE PERFORMANCE (619) 561-7764

HOSE SPECIFICATIONS

-8 Low Pressure Hose Specs: Hose I.D. .50", Hose O.D. .75", 250 PSI, 300 degrees Fahrenheit

-10 Low Pressure Hose Specs: Hose I.D. .63", Hose O.D. .91", 250 PSI, 300 degrees Fahrenheit

-6 High Pressure Hose Specs: Hose I.D. 5/16", Hose O.D. 43/64", 2,250 working PSI, 9,000 Burst PSI, 302 degrees