

HYDRO-BOOST WITH RAM ASSIST (TC PUMP)

Hose installation diagram

POWER STEERING FLUID: Howe Power Steering Fluid PN 1105
(GM AC Delco PN: 19329448 may be substituted if needed)

CAUTION:
DO NOT USE ATF (AUTOMATIC TRANSMISSION FLUID)

NOTE: Hose lengths will vary with each installation, custom hoses must be fabricated.
Hose kits p/n 950 available separately.

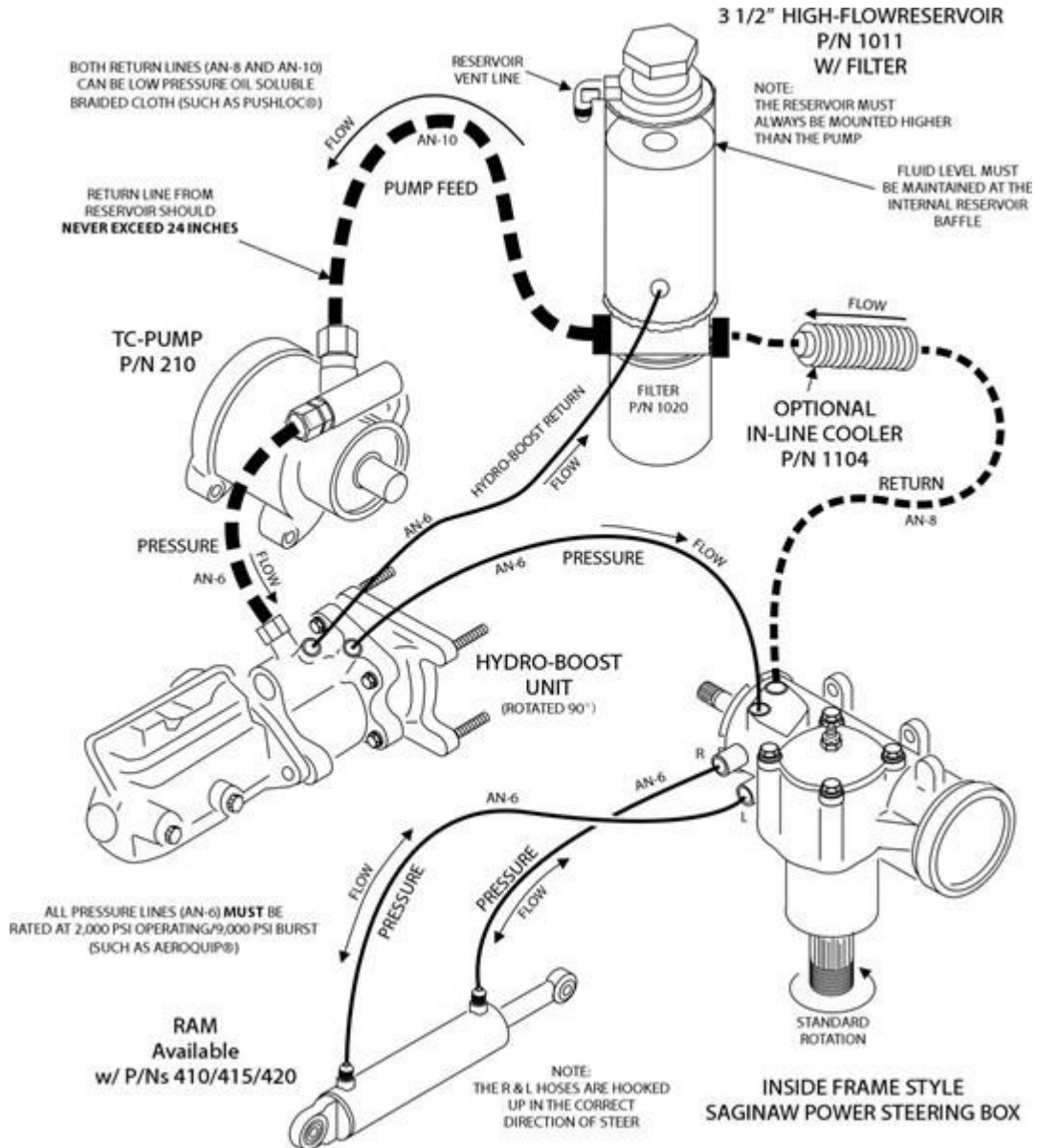

IF YOU HAVE ANY QUESTIONS ABOUT THE INSTALL CALL HOWE PERFORMANCE (619) 561-7764

HOSE SPECIFICATIONS

- 8 Low Pressure Hose Specs: Hose I.D. .50", Hose O.D. .75", 250 PSI, 300 degrees Fahrenheit
- 10 Low Pressure Hose Specs: Hose I.D. .63", Hose O.D. .91", 250 PSI, 300 degrees Fahrenheit
- 6 High Pressure Hose Specs: Hose I.D. 5/16", Hose O.D. 43/64", 2,250 working PSI, 9,000 Burst PSI, 302 degrees