

TRUGGY POWER STEERING SYSTEM WITH ALUM. PUMP and RELIEF VALVE

Hose installation diagram

POWER STEERING FLUID: Howe Power Steering Fluid PN 1105
(GM AC Delco PN:19329448 may be substituted if needed)

CAUTION: DO NOT USE ATF (AUTOMATIC TRANSMISSION FLUID)

Use only Sta-Lube Marine grease p/n SI3120 (tube), SI3121 (tub), any other will void warranty

NOTE: Hose lengths will vary with each installation, custom hoses must be fabricated.
Hose kits are available separately.

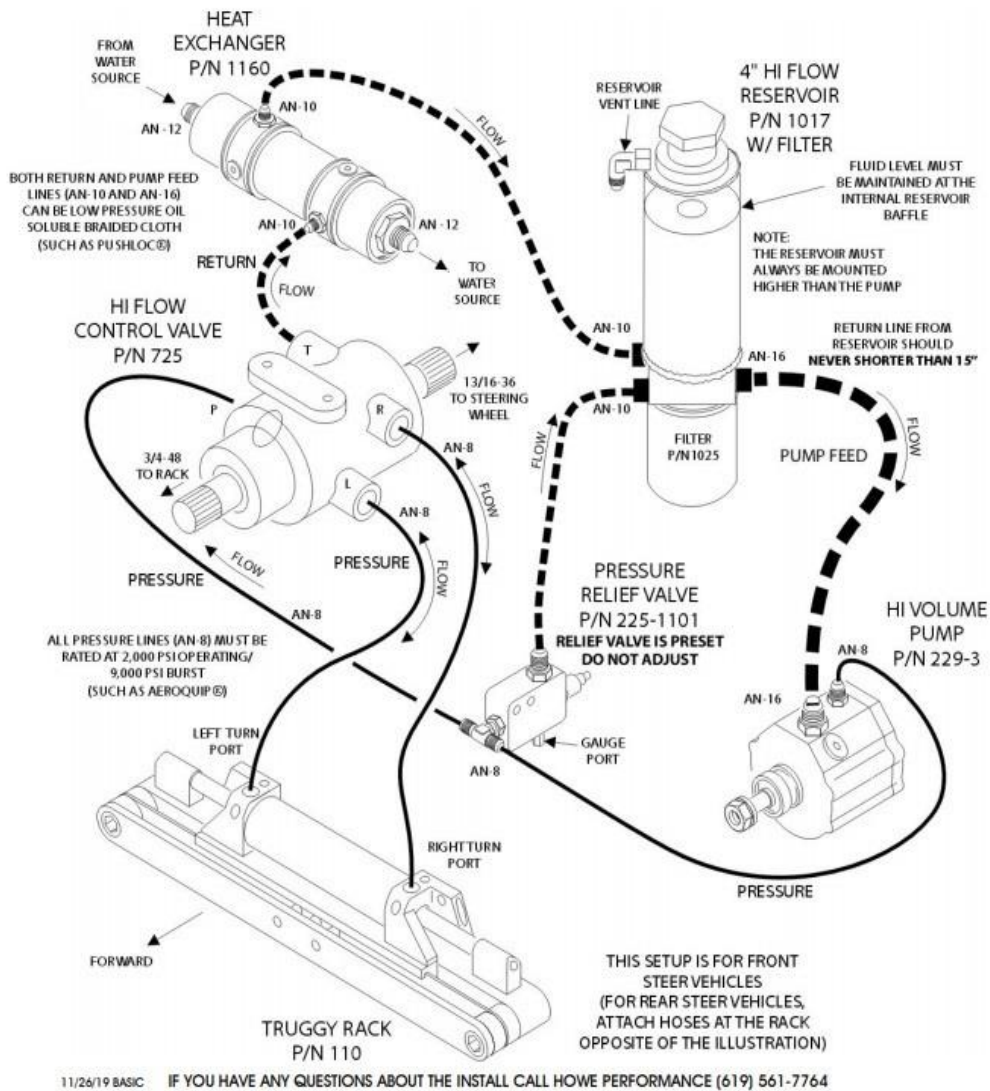

6/28/21 basic

HOSE SPECIFICATIONS

-10 Low Pressure Hose Specs: Hose I.D. .63", Hose O.D. .91", 250 PSI, 300 degrees Fahrenheit

-16 Low Pressure Hose Specs: Hose I.D. 1.086

-8 High Pressure Hose Specs: Hose I.D. 13/32", Hose O.D. 49/64", 2,000 Working PSI, 8,000 Burst PSI, 302 degrees